

Please read these instructions before installation and retain this instruction manual for future reference.

Important user information

- We recommend that luminaires be installed by a qualified electrician.
- We cannot be held liable for any issues that may arise due to an improper installation.
- Maximum voltage and wattage: 240V, 50W. This luminaire is for indoor use only.
- Avoid installing 50W lamps in this luminaire if it will be mounted on flammable surfaces.
- Before starting the installation or performing maintenance, make sure to switch off the electricity supply at the mains.
- Under no circumstances should the luminaire be covered with insulation material, and installation of luminaires near flammable materials is strictly prohibited.
- Ensure there is sufficient free air circulation of at least 50mm around the luminaire. Since all luminaires generate heat, it is the installer's responsibility to assess fire risks and implement necessary precautions.
- Dispose of electrical and electronic equipment correctly, not with household waste, for proper treatment and recovery.

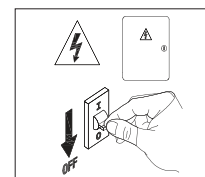
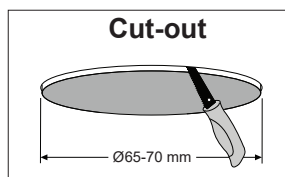
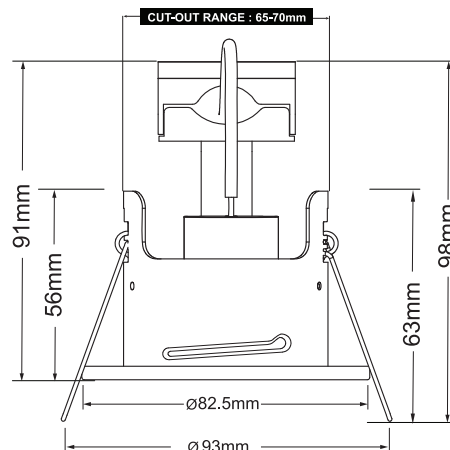

Installation instructions

1. Choose the desired location for the luminaire, ensuring that the clearances shown in Figure 1 are observed. Exercise caution regarding joists, electrical cables and water pipes.

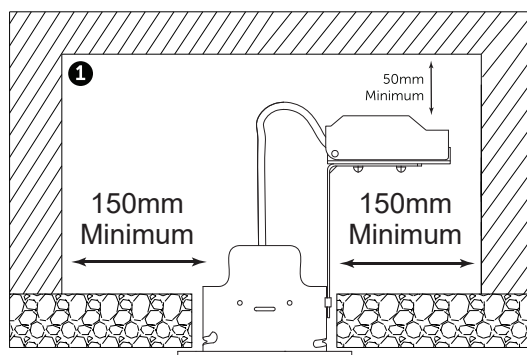

2. The fitting is supplied with a 240V GU10 lamp holder pre-installed. Use a screwdriver to release the cord grip and access the tool-less terminal. Connect the luminaire to the power supply for the lamp using the provided terminal block (refer to Figure 2).

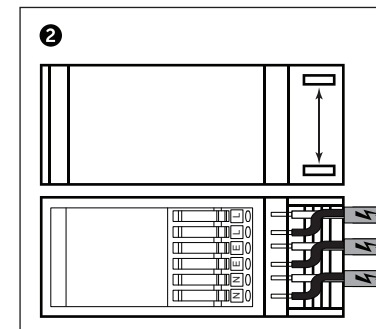

IMPORTANT
Make sure all electrical connections are secure, Without any loose strands, including factory-made components.

3. Insert the legs of the mounting spring clips into the ceiling cut-out, then push the luminaire into the aperture. Ensure that the legs are unobstructed to guarantee a secure placement on the ceiling (refer to Figure 3).

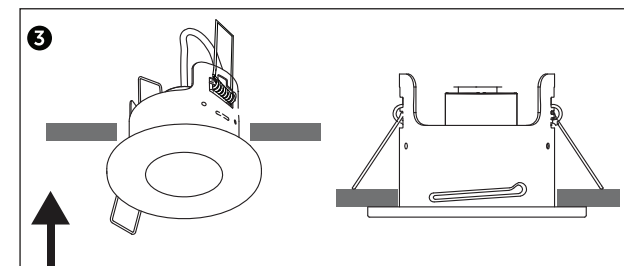

To replace lamp:

- Twist the bezel anticlockwise to remove it, then insert the lamp into the back of the bezel.
- Connect the lamp to the GU10 lamp holder.
- Securely reconnect the bezel to the downlight body by twisting it clockwise.