

Please read: Important safety instructions  
This manual has instructions on how to setup and register your new smart LED light bulb.

### Introduction

This LED light bulb enables you to Setup a special, coloured lighting theme to complement your decor or your mood.

It is Bluetooth and Wi-Fi enabled, and is controlled with your IOS or Android smartphone or tablet.

### What's in the box

Your product package contains the following items. Save your sales receipt and original packaging in the event warranty service is necessary.

- Multi-Colour Smart LED light bulb
- User manual



### Installation steps

#### Install the LED light bulb

- Make sure that the power is off when installing, removing, or examining the light bulb.

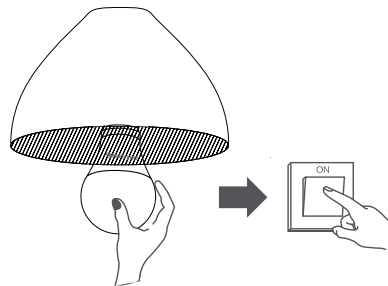

#### Note:

1. Do not use this product in a damp environment.
2. Do not use the light bulb in a narrow and ill-ventilated lamp shade as it may cause weak signals or heat dissipation issues.

#### Download the App

Scan the QR code below to download the paul russells app and create your account.



#### Setup a new light bulb

Open the app and operate it in accordance with the instructions provided in the app.

\* Make sure the Wi-Fi network is available and is able to access the Internet properly.

**Note: Wi-Fi 2.4 GHz required**

Your bulb should be flashing upon inserting into the fittings. If not use the light switch to turn the light bulb on and off three times. (allowing app connection)

**The Bulb will start to flash.**

In the app, Locate in the upper right corner, the button Within a moment, will prompt "Devices to add". If the notice does not appear, select "Lighting" and follow the steps in the app.

**You already have the light bulb linked to your smart device and ready to use.**

### General product care

#### Taking care of your LED light bulb

Your LED light bulb contains sophisticated electronic parts, so it must be treated with care.

#### Avoid rough treatment

Place the LED light bulb down gently. Save the original packing materials to protect your LED light bulb if you ever need to ship it.

#### Avoid water

Your LED light bulb can be damaged if it gets wet. Do not use the LED light bulb outdoors in the rain, or handle it with wet hands. Do not install the LED light bulb near a sink, bathtub or shower.

#### Electrical storms

Electrical storms can sometimes cause power surges harmful to electronic equipment. For your own safety, take caution when using electrical appliances during storms.

#### Cleaning your LED light bulb

Your LED light bulb has a durable plastic casing that should retain its luster for many years. Clean it only with a dry non-abrasive cloth. Do not use dampened cloth or cleaning solvents of any kind.

### Warning

1. Before using this product, please make sure that your voltage is appropriate for the working voltage of this product. Using this product with a voltage other than the one specified may damage the product and cause safety hazards.
2. Do not disassemble this product, as the light diodes can cause damage to the eyes.
3. The light bulb will heat up when working. Do not use it in a confined holder for an extended period of time. Ensure sufficient ventilation for the light bulb to allow for heat dissipation.
4. For indoor use only.
5. Disconnect power before installation to prevent risk of electronic shock.
6. Use in dry locations only.
7. The light source of this product is irreplaceable light diodes(LED).

8. This light bulb is neither intended for use with emergency exits nor intended for emergency lighting.
9. Only use the control provided with or specified by these instructions to control this Light bulb. This light bulb will not operate properly when connected to a standard (incandescent) dimmer or dimming control.
10. Adult supervision is required.

[www.paulrussells.com](http://www.paulrussells.com)

Thank you

**paul russells®**

**Smart  
LED Bulb**

**User Manual**