

Please read these instructions before installation and keep this manual for future reference.

Important user information

- Installation must be carried out by a qualified electrician or technician.
- We cannot be held liable for any issues that may arise due to improper installation.
- Maximum voltage and wattage: 240V, 35W.
- Avoid installing 35W lamps in this luminaire if it will be mounted on flammable surfaces.
- Before starting installation or performing maintenance, ensure the electricity supply is switched off at the mains.
- Under no circumstances should the luminaire be covered with insulation material, and the installation of luminaires near flammable materials is strictly prohibited.
- Ensure there is a minimum of 50mm free air circulation around the luminaire to allow for sufficient ventilation. It is the responsibility of the installer to assess fire risks and implement necessary precautions.
- Dispose of electrical and electronic equipment properly; do not dispose of it with household waste. It needs to be treated and recovered correctly.

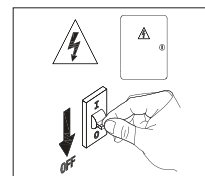
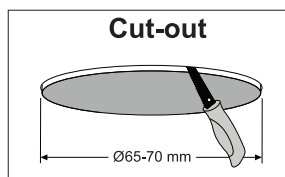
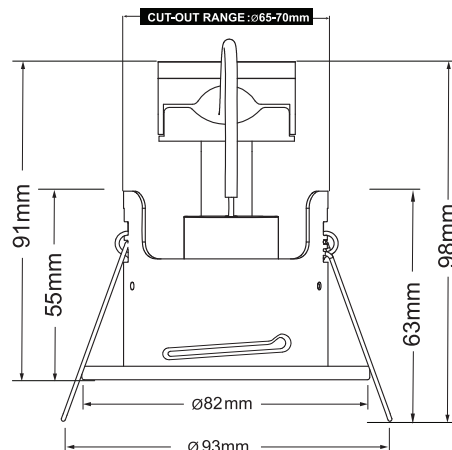

Installation instructions

1. Choose the desired location for the luminaire, ensuring that the clearances shown in Figure 1 are observed. Exercise caution regarding joists, electrical cables and water pipes.

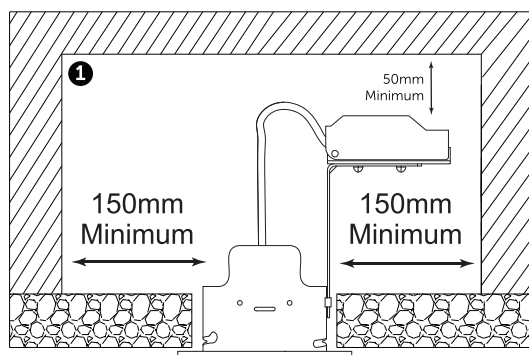

2. The fitting is supplied with a 240V GU10 lamp holder pre-installed. Use a screwdriver to release the cord grip and access the tool-less terminal. Connect the luminaire to the power supply for the lamp using the provided terminal block (Figure 2).

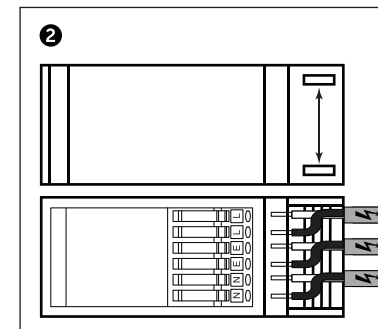

IMPORTANT
Make sure all electrical connections are secure, Without any loose strands, including factory made components.

3. Insert the legs of the mounting spring clips into the ceiling cut-out, then push the luminaire into place. Ensure that the legs are unobstructed to guarantee secure placement on the ceiling (Figure 3).

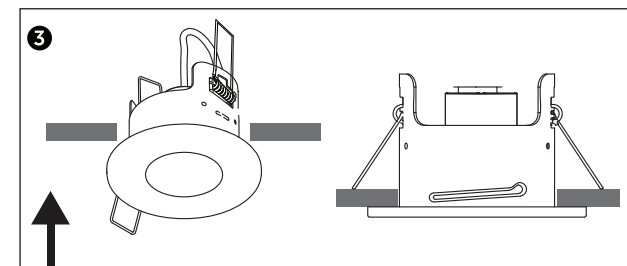

To replace lamp:

- Twist the bezel anticlockwise to remove it, then insert the lamp into the back of the bezel.
- Connect the lamp to the GU10 lamp holder.
- Securely reconnect the bezel to the downlight body by twisting it clockwise.

